



MUSEUMS  
& GALLERIES

# DUNFERMLINE CARNEGIE LIBRARY AND GALLERIES

## COMMUNITY GALLERY DETAILS AND SPECIFICATIONS

# Community Gallery

The Community Gallery at DCLG provides a light, welcoming space to display a range of artworks.

This document shows:

- Available Wall Space in galleries 1 and 2.
- Available Floor Space in galleries 1 and 2.
- Details of our hanging system.
- Venue information.
- Guidelines for selling.

## Location

DCLG is located on Abbot Street, Dunfermline and the Community Gallery is in the original entrance hallway at the north east corner of the building's ground floor.

**Building Location**

**3D Venue tour**

## Access

We strive to make all our venues accessible. DCLG includes:

- Ramp to front entrance
- Automatic entrance doors
- Lift to all floors
- All abilities toilets throughout the venue
- Changing places facility
- Wheelchair available on request

If you have any access requirements please contact [ross.christie@onfife.com](mailto:ross.christie@onfife.com)

## **Hanging System**

The Community Gallery uses the Avante hanging system. This can be used for ease of hanging works and avoids any damage to the walls of the building.

Details of the system specific to our gallery spaces can be found here:

**[AVANTE hanging system at OnFife](#)**

## **Gallery Sales**

The Community Gallery is not a commercial art space available for hire. Works may be sold, but this must be discussed with the gallery at the early stages of planning.

If agreed, the gallery will take 30% commission on all sales.

If works are to be sold please send a list of works available, including artist, title, materials and price to [ross.christie@onfife.com](mailto:ross.christie@onfife.com), at least two weeks in advance of your exhibition opening date.

## **Previews/opening events**

We are happy to hold previews for Community Gallery exhibitions if they are timed to fit with the opening hours of the venue. Refreshments can be provided by our 'in house' caterers if the costs are covered by the exhibitors. Exhibitors are not permitted to provide their own refreshments.

The Community Gallery will hold around 40 people, and this should be taken into account when planning previews.

# GALLERY 1

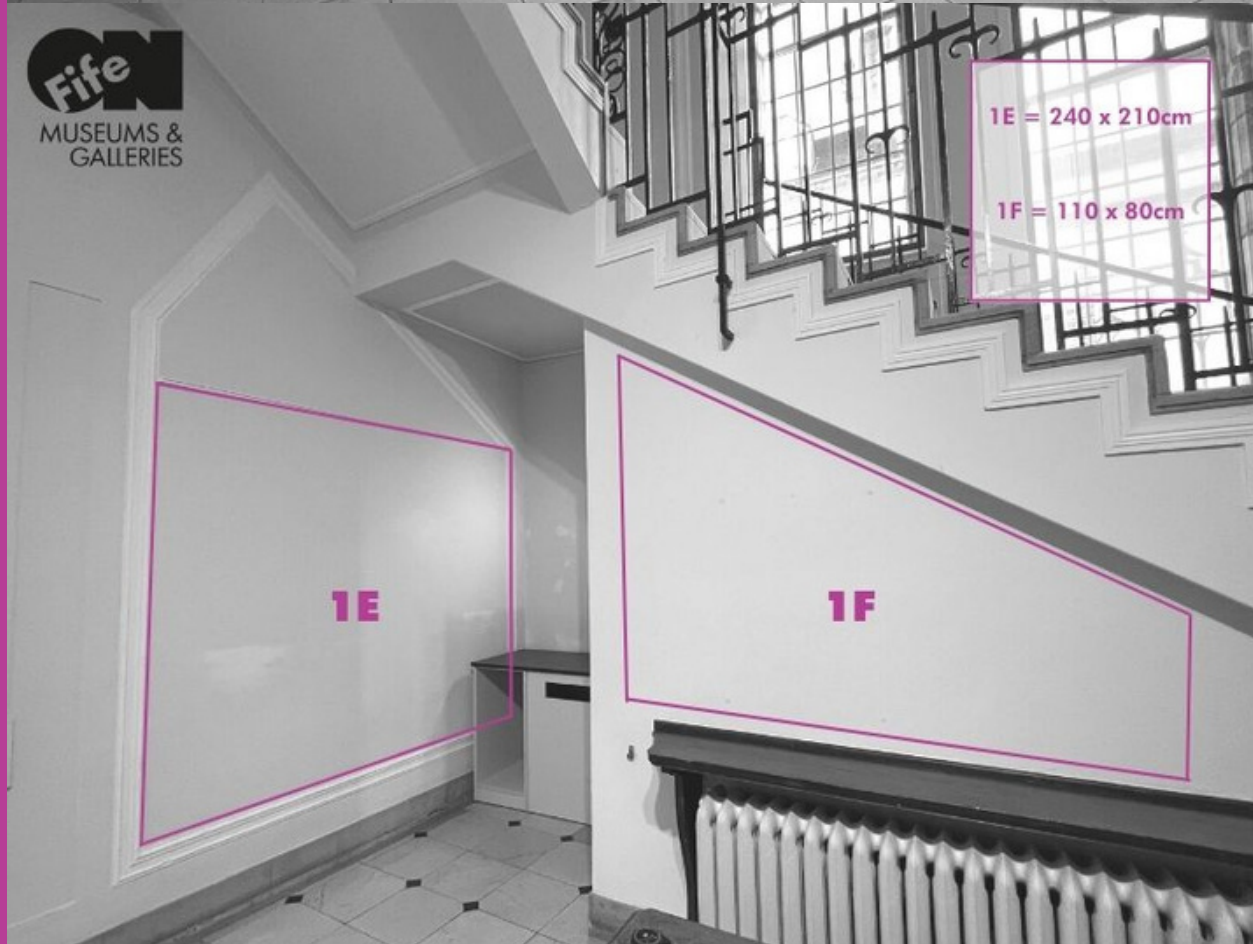

# GALLERY 2



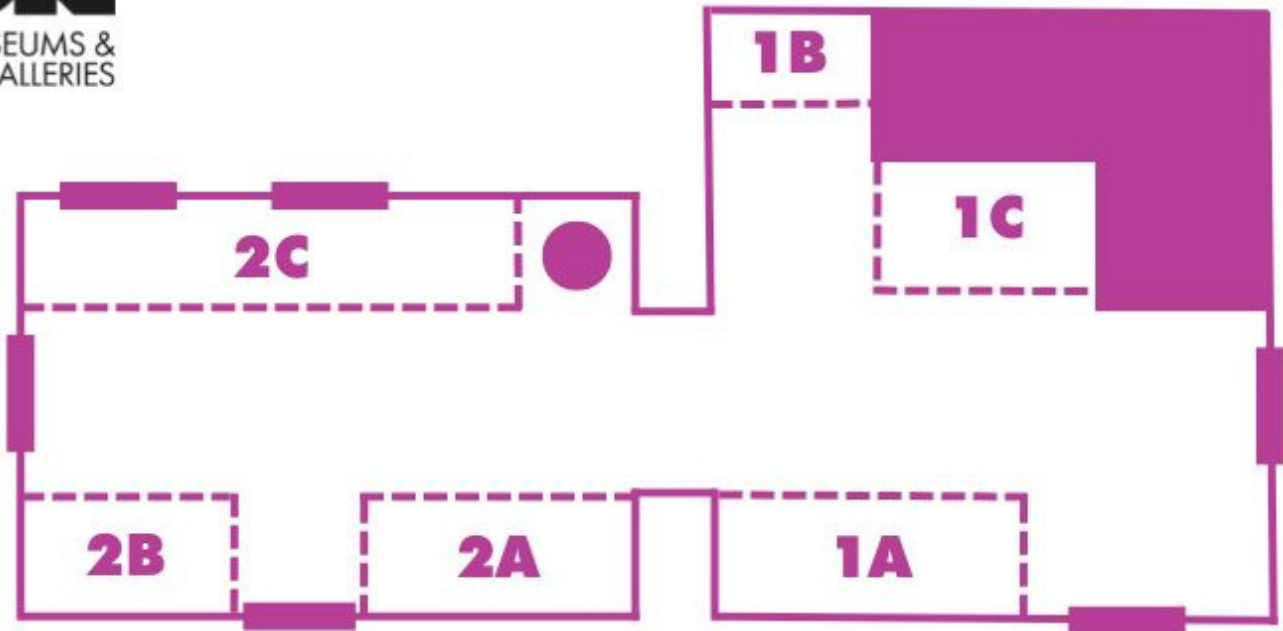

## Available floor space

1A = 130 x 270cm    2A = 130 x 300cm  
1B = 110 x 110cm    2B = 140 x 230cm  
1C = 180 x 270cm    2C = 150 x 620cm

Available floor space is limited to the six areas outlined in the above floorplan.

Due to Health and Safety regulations there must be a safe walkway from the gallery entrance to the fire exit onto Abbot Street. Nothing can block this area.